

Wartungsfreie Gelenkköpfe

Rod ends, maintenance-free

GK ... L

d = 20 ... 80 mm

montiertes Gelenklager: GE...HW-A nach DIN ISO 12240-1, Maßreihe E (Tabelle 1)
spherical plain bearing: GE...HW-A as per DIN ISO 12240-1, dimension series E (table 1)



Abmessungen:
 DIN ISO 12240-4, Maßreihe E (Tabelle 1)

Dimensions:
 DIN ISO 12240-4, dimension series E (table 1)

leichte Ausführung
light duty design

für Hunger-Hydraulikzylinder HHN 816
for Hunger hydraulic cylinder HHN 816

Typ Type	d	B	h ₁	d ₃	l ₃	d ₂	d ₅	w	Tragzahlen/Load ratings	
									statisch static C ₀ kN	dynamisch dynamic C kN
mm										
GK 20 L	20 ^{-0,010}	16 ^{-0,12}	77	M 20 x 1,5	40	47	34	32	43	31,5
GK 25 L	25 ^{-0,010}	20 ^{-0,12}	94	M 24 x 2,0	48	55	42	36	60	51,0
GK 30 L	30 ^{-0,010}	22 ^{-0,12}	110	M 30 x 2,0	56	65	50	41	80	65,5
GK 35 L	35 ^{-0,012}	25 ^{-0,12}	125	M 36 x 3,0	60	78	58	50	153	112,0
GK 40 L	40 ^{-0,012}	28 ^{-0,12}	142	M 39 x 3,0	65	88	65	55	190	140,0
GK 45 L	45 ^{-0,012}	32 ^{-0,12}	145	M 42 x 3,0	65	98	70	60	257	180,0
GK 50 L	50 ^{-0,012}	35 ^{-0,12}	160	M 45 x 3,0	68	111	75	65	324	220,0
GK 60 L	60 ^{-0,015}	44 ^{-0,15}	175	M 52 x 3,0	70	130	88	75	460	345,0
GK 70 L	70 ^{-0,015}	49 ^{-0,15}	200	M 56 x 4,0	80	149	98	85	551	440,0
GK 80 L	80 ^{-0,015}	55 ^{-0,15}	230	M 64 x 4,0	85	172	110	100	730	570,0

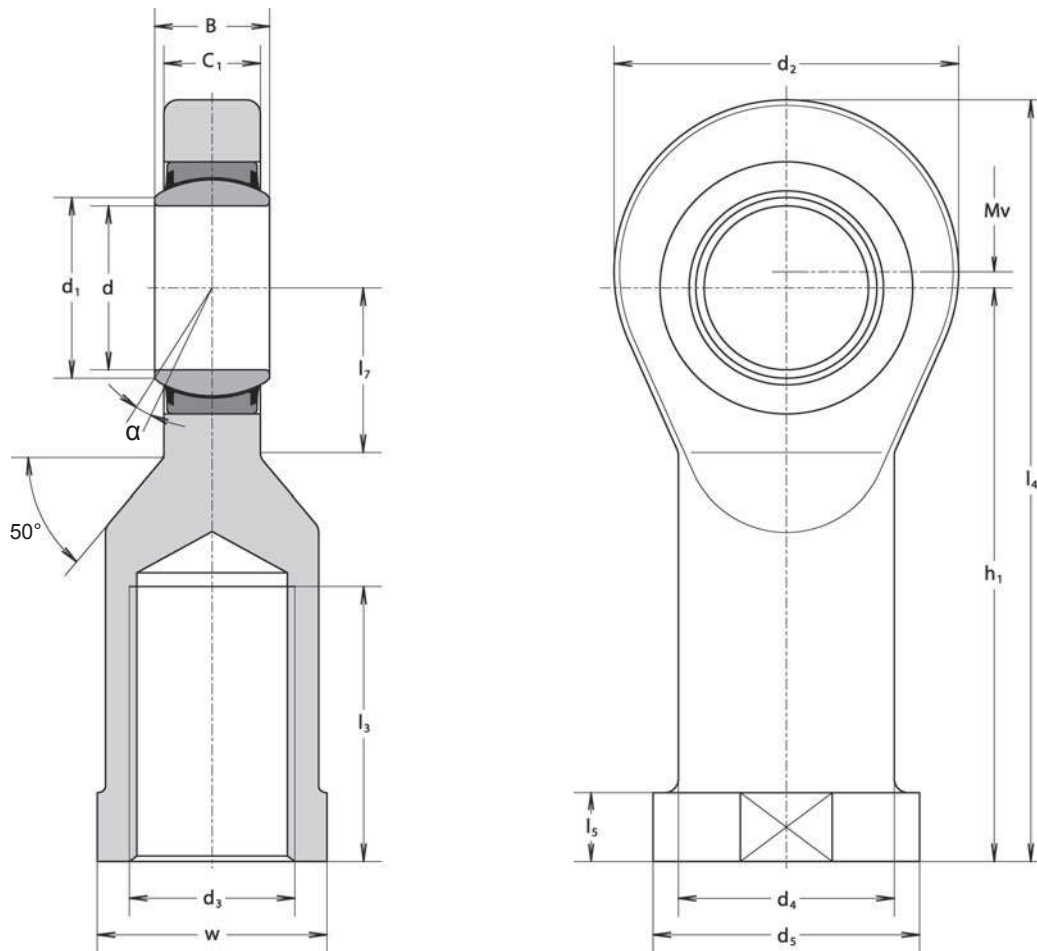

Typ Type	α	d_1	C_1	l_4	l_7	l_5	d_4	Mv	Masse Mass	Artikelnr. Item no.
	°	mm							kg	
GK 20 L	9	24,0	13	102,5	23	10	27,5	2,0	0,33	025 700
GK 25 L	7	29,0	17	124,0	27	12	33,5	2,5	0,61	025 701
GK 30 L	6	34,0	19	145,0	30	15	40,0	2,5	0,95	025 702
GK 35 L	6	39,5	21	167,5	37	15	47,0	3,5	1,40	025 703
GK 40 L	7	45,0	23	190,0	44	18	52,0	4,0	2,00	025 704
GK 45 L	7	50,5	27	198,5	48	20	58,0	4,5	2,50	025 705
GK 50 L	6	56,0	30	221,0	58	20	62,0	5,5	3,50	025 706
GK 60 L	6	66,5	38	246,0	68	20	70,0	6,0	5,60	025 707
GK 70 L	6	77,5	42	281,5	78	20	80,0	7,0	8,40	025 708
GK 80 L	6	89,0	47	324,0	91	25	95,0	8,0	12,30	025 709