

Wartungsfreie Schräggelenklager

Angular contact spherical plain bearings, maintenance-free

GE ... HSW

d = 25 ... 300 mm

Abmessungen: wie Kegelrollenlager DIN 720 Serie 320-X
bzw. ISO 335 Serie 320-X nach DIN ISO 12240-2

Dimensions: as for tapered roller bearing DIN 720 series 320-X 720
or ISO 335 Series 320-X as per DIN ISO 12240-2



Kippwinkel α 0,8...1,2°
Tilting angle α 0.8 ... 1.2°

Typ Type	d mm	D	H	C	s	d _k	Tragzahlen/Load ratings	
							statisch static C ₀ kN	dynamisch dynamic C kN
GE 25 HSW	25 ^{-0,012}	47 ^{-0,014}	15 ^{±0,25}	14 ^{-0,20}	1,0	42,5	140	71
GE 30 HSW	30 ^{-0,012}	55 ^{-0,016}	17 ^{±0,25}	16 ^{-0,20}	2,0	50,0	190	95
GE 35 HSW	35 ^{-0,012}	62 ^{-0,016}	18 ^{±0,25}	17 ^{-0,24}	2,0	56,0	232	116
GE 40 HSW	40 ^{-0,012}	68 ^{-0,016}	19 ^{±0,25}	18 ^{-0,24}	1,5	60,0	270	134
GE 50 HSW	50 ^{-0,012}	80 ^{-0,016}	20 ^{±0,25}	19 ^{-0,24}	4,0	74,0	355	176
GE 60 HSW	60 ^{-0,015}	95 ^{-0,018}	23 ^{±0,25}	22 ^{-0,30}	5,0	86,0	480	240
GE 70 HSW	70 ^{-0,015}	110 ^{-0,018}	25 ^{±0,25}	24 ^{-0,30}	7,0	102,0	630	315
GE 75 HSW	75 ^{-0,015}	115 ^{-0,018}	25 ^{±0,25}	24 ^{-0,30}	7,0	105,0	655	325
GE 80 HSW	80 ^{-0,015}	125 ^{-0,020}	29 ^{±0,25}	27 ^{-0,30}	10,0	115,0	750	375
GE 90 HSW	90 ^{-0,020}	140 ^{-0,020}	32 ^{±0,25}	30 ^{-0,40}	11,0	130,0	965	480
GE 100 HSW	100 ^{-0,020}	150 ^{-0,020}	32 ^{±0,25}	30 ^{-0,40}	12,0	140,0	1040	520
GE 110 HSW	110 ^{-0,020}	170 ^{-0,025}	38 ^{±0,25}	36 ^{-0,40}	15,0	160,0	1430	710
GE 120 HSW	120 ^{-0,020}	180 ^{-0,025}	38 ^{±0,25}	36 ^{-0,40}	17,0	170,0	1530	765
GE 130 HSW	130 ^{-0,025}	200 ^{-0,030}	45 ^{±0,35}	42 ^{-0,50}	20,0	190,0	1930	965
GE 140 HSW	140 ^{-0,025}	210 ^{-0,030}	45 ^{±0,35}	42 ^{-0,50}	20,0	200,0	2040	1020
GE 150 HSW	150 ^{-0,025}	225 ^{-0,030}	48 ^{±0,35}	45 ^{-0,50}	21,0	213,0	2360	1180
GE 160 HSW	160 ^{-0,025}	240 ^{-0,030}	51 ^{±0,35}	48 ^{-0,50}	21,0	225,0	2700	1340
GE 170 HSW	170 ^{-0,025}	260 ^{-0,035}	57 ^{±0,35}	54 ^{-0,50}	27,0	250,0	3350	1660
GE 180 HSW	180 ^{-0,025}	280 ^{-0,035}	64 ^{±0,35}	61 ^{-0,50}	21,0	260,0	4000	2000
GE 190 HSW	190 ^{-0,030}	290 ^{-0,035}	64 ^{±0,35}	61 ^{-0,60}	29,0	275,0	4150	2080
GE 200 HSW	200 ^{-0,030}	310 ^{-0,035}	70 ^{±0,35}	66 ^{-0,60}	26,0	290,0	4750	2360
GE 220 HSW	220 ^{-0,030}	340 ^{-0,040}	76 ^{±0,35}	72 ^{-0,60}	30,0	320,0	5700	2850
GE 240 HSW	240 ^{-0,030}	360 ^{-0,040}	76 ^{±0,35}	72 ^{-0,60}	32,0	340,0	6100	3050
GE 260 HSW	260 ^{-0,035}	400 ^{-0,040}	87 ^{±0,35}	83 ^{-0,70}	33,5	375,0	7800	3900
GE 280 HSW	280 ^{-0,035}	420 ^{-0,045}	87 ^{±0,35}	83 ^{-0,70}	45,0	400,0	8300	4150
GE 300 HSW	300 ^{-0,035}	460 ^{-0,045}	100 ^{±0,35}	96 ^{-0,70}	38,0	430,0	10400	5200

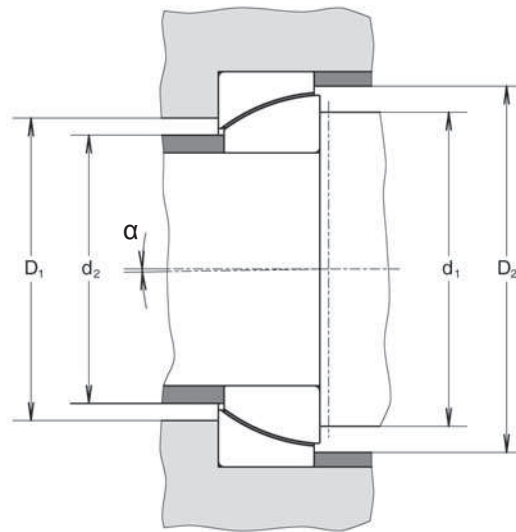
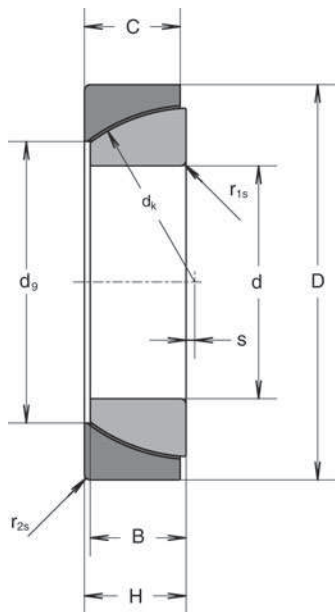

Typ Type	d_g	B	r_{1s}	r_{2s}	d_{1max}	d_{2max}	D_{1min}	D_{2min}	Masse Mass	Artikelnr. Item no.
	mm									
	kg									
GE 25 HSW	31,4	14 ^{-0,20}	0,6	0,2	39,5	30,1	34,0	43,0	0,14	300 500
GE 30 HSW	36,1	16 ^{-0,20}	1,0	0,3	45,0	34,6	40,5	50,5	0,22	300 502
GE 35 HSW	42,4	17 ^{-0,24}	1,0	0,3	50,0	41,1	47,0	57,0	0,28	300 504
GE 40 HSW	46,8	18 ^{-0,24}	1,0	0,3	54,0	45,5	52,0	61,0	0,34	300 505
GE 50 HSW	59,1	19 ^{-0,24}	1,0	0,3	67,0	57,9	65,0	75,0	0,47	300 507
GE 60 HSW	68,1	22 ^{-0,30}	1,5	0,6	77,0	66,9	76,0	87,0	0,75	300 509
GE 70 HSW	82,2	24 ^{-0,30}	1,5	0,6	92,0	80,9	90,0	104,0	1,00	300 511
GE 75 HSW	85,9	24 ^{-0,30}	1,5	0,6	95,0	84,7	94,0	107,0	1,10	300 512
GE 80 HSW	90,5	27 ^{-0,30}	1,5	0,6	104,0	88,0	99,0	117,0	1,60	300 513
GE 90 HSW	103,3	30 ^{-0,40}	2,0	0,6	118,0	100,8	112,0	132,0	2,20	300 515
GE 100 HSW	114,3	30 ^{-0,40}	2,0	0,6	128,0	112,0	123,0	142,0	2,40	300 517
GE 110 HSW	125,8	36 ^{-0,40}	2,5	0,6	146,0	123,2	135,0	162,0	3,70	300 519
GE 120 HSW	135,4	36 ^{-0,40}	2,5	0,6	155,0	132,9	145,0	172,0	4,00	300 520
GE 130 HSW	148,0	42 ^{-0,50}	2,5	0,6	174,0	143,9	158,0	192,0	6,00	300 521
GE 140 HSW	160,6	42 ^{-0,50}	2,5	0,6	184,0	156,9	171,0	202,0	6,40	300 522
GE 150 HSW	170,9	45 ^{-0,50}	3,0	1,0	194,0	167,1	184,0	216,0	7,90	300 523
GE 160 HSW	181,4	48 ^{-0,50}	3,0	1,0	206,0	177,7	195,0	228,0	9,60	300 524
GE 170 HSW	194,3	54 ^{-0,50}	3,0	1,0	228,0	190,4	208,0	253,0	13,00	300 525
GE 180 HSW	205,5	61 ^{-0,50}	3,0	1,0	240,0	201,7	220,0	263,0	17,50	300 526
GE 190 HSW	211,8	61 ^{-0,60}	3,0	1,0	252,0	207,9	226,0	278,0	18,00	300 527
GE 200 HSW	229,2	66 ^{-0,60}	3,0	1,0	268,0	224,1	244,0	293,0	23,00	300 528
GE 220 HSW	251,6	72 ^{-0,60}	4,0	1,0	296,0	246,5	267,0	324,0	30,00	300 529
GE 240 HSW	273,8	72 ^{-0,60}	4,0	1,0	315,0	268,9	290,0	344,0	32,50	300 530
GE 260 HSW	298,8	83 ^{-0,70}	5,0	1,1	347,0	293,8	318,0	379,0	48,00	300 531
GE 280 HSW	312,5	83 ^{-0,70}	5,0	1,1	367,0	307,3	332,0	404,0	51,00	300 532
GE 300 HSW	341,2	96 ^{-0,70}	5,0	1,1	399,0	336,2	362,0	435,0	73,00	300 533